

AVAO BOD / AVAO BOD FAST



EN 361: 2002
EN 358: 2018
EN 813: 2008



Fall arrest body harness, work positioning and restraint belt and seat harness for work at height.
Harnais complet d'antichute, ceinture de maintien et de retenue et harnais cuissard pour travaux en hauteur

WARNING / ATTENTION

Activities involving the use of this equipment are inherently dangerous. You are responsible for your own actions and decisions.

Before using this equipment, you must:
- Read and understand all instructions for Use.
- Get specific training in its proper use.
- Become acquainted with its capabilities and limitations.
- Understand and accept the risks involved.

FAILURE TO HEED ANY OF THESE WARNINGS MAY RESULT IN SEVERE INJURY OR DEATH.

Les activités impliquant l'utilisation de cet équipement sont par nature dangereuses. Vous êtes responsable de vos actes, de vos décisions et de votre sécurité.

Avant d'utiliser cet équipement, vous devez :
- Lire et comprendre toutes les instructions d'utilisation.
- Vous former spécifiquement à l'utilisation de cet équipement.
- Vous familiariser avec votre équipement, apprendre à connaître ses performances et ses limites.
- Comprendre et accepter les risques inhérents.

LE NON-RESPECT D'UN SEUL DE CES AVERTISSEMENTS PEUT ÊTRE LA CAUSE DE BLESSURES GRAVES OU MORTELLES.

PRICE

5. How to put the harness on / Mise en place du harnais

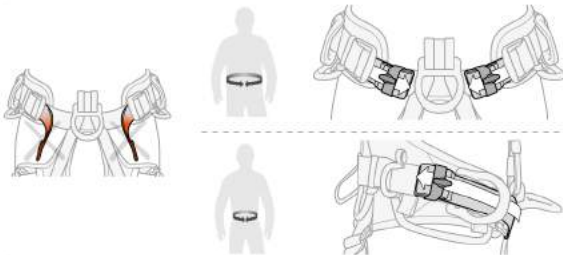
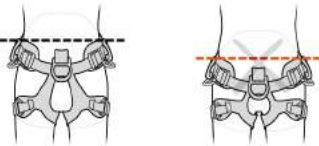
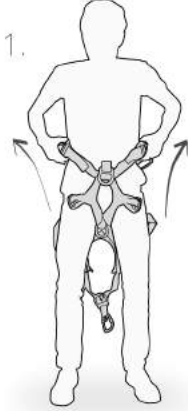

1. Field of application / Champ d'application

2. Nomenclature

AVAO BOD

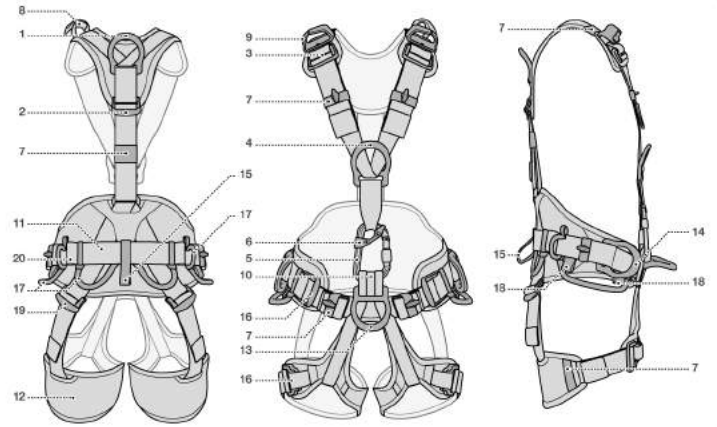

AVAO BOD FAST



4. Compatibility / Compatibilité

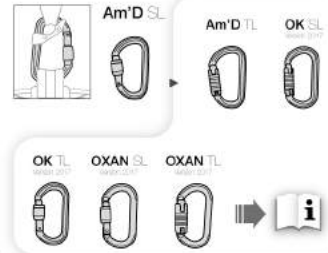

3. Inspection, points to verify / Contrôle, points à vérifier

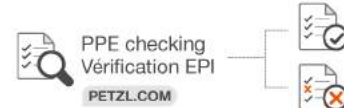

5. How to put the harness on
Mise en place du harnais

3.



4.



5.

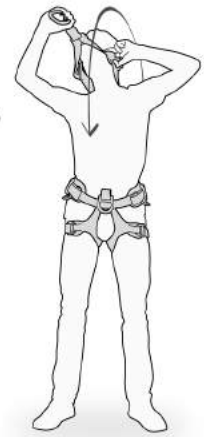

AVAO BOD

Close / Fermer



Open / Ouvrir



AVAO BOD FAST

Close/
Fermer



CLIC!



Open / Ouvrir

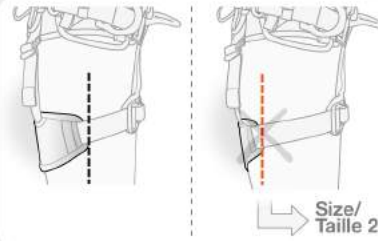

6.



7.

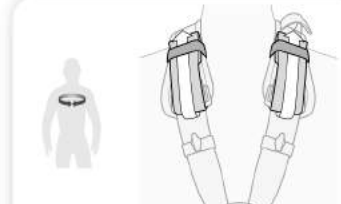
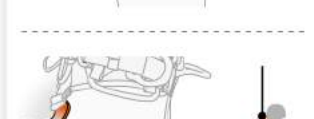
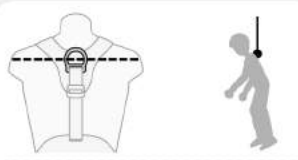
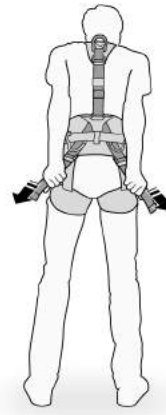



A. Lifetime / Durée de vie

∞ unlimited / illimitée

C. Acceptable T° / T° tolérées

+80°C / +176°F
-40°C / -40°F

D. Precautions for use / Précautions d'usage



E. Cleaning / Nettoyage



F. Drying / Séchage



G. Storage - Transport / Stockage - transport



H. Maintenance / Entretien



I. Modifications - Repairs / Modifications - Réparations



J. FAQ - Contact / Questions - Contact



6. EN 361: 2002 fall arrest harness / Harnais antichute EN 361: 2002

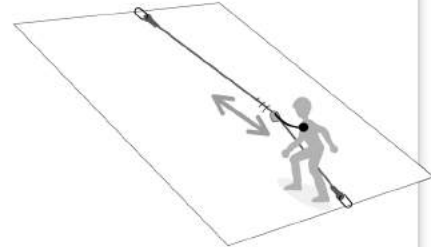
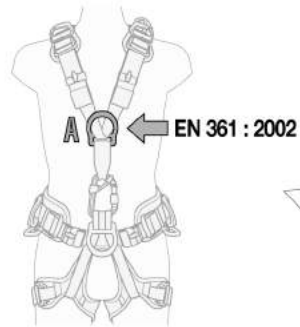
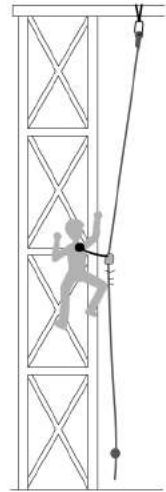
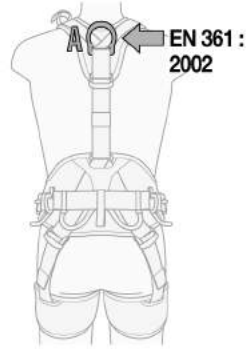

7. EN 358: 2018 belt for work positioning and restraint / Ceinture de maintien au travail et retenue EN 358: 2018

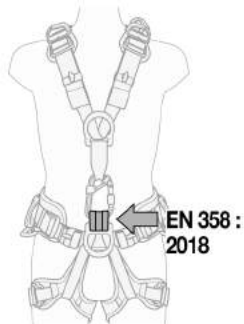
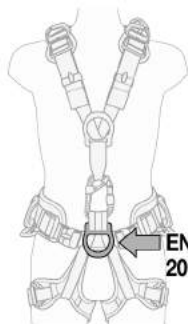
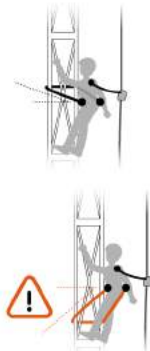

7. EN 358: 2018 belt for work positioning and restraint
Ceinture de maintien au travail et retenue EN 358: 2018

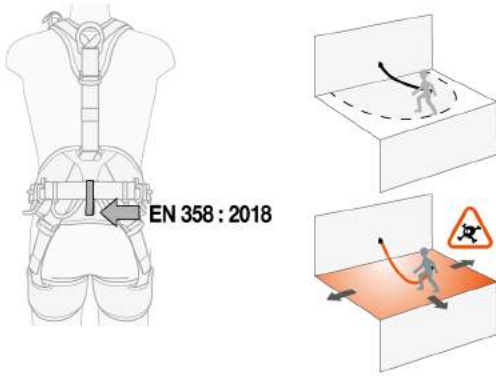

9. CAPTIV connector positioning bar
Barette de maintien de connecteur CAPTIV

Installation

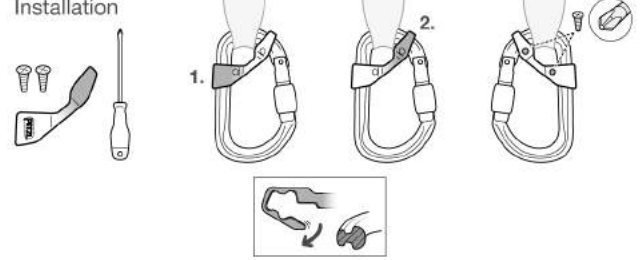

8. Seat harness EN 813: 2008
Harnais cuissard EN 813: 2008

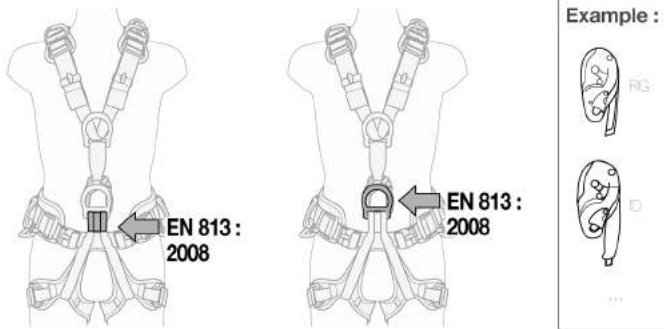

10. Equipment loops
Porte-matériels

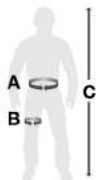
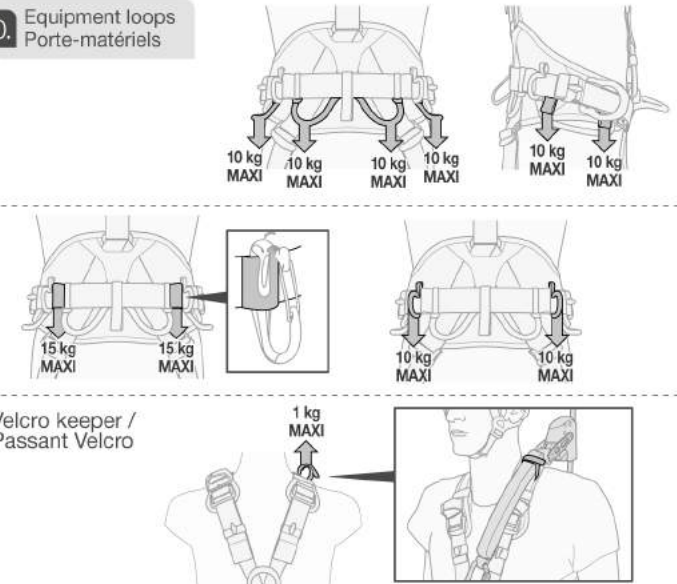

	A	B	C
Size / Taille 0	65 - 80 cm 26 - 39 inch	44 - 59 cm 18 - 23 inch	160 - 180 cm 63 - 70 inch
Size / Taille 1	70 - 93 cm 28 - 36 inch	47 - 62 cm 19 - 24 inch	165 - 185 cm 65 - 72 inch
Size / Taille 2	83 - 120 cm 33 - 46 inch	50 - 65 cm 20 - 25 inch	175 - 200 cm 69 - 78 inch

11. Fall arrest lanyard connector holder
Porte-connecteurs de longue d'antichute

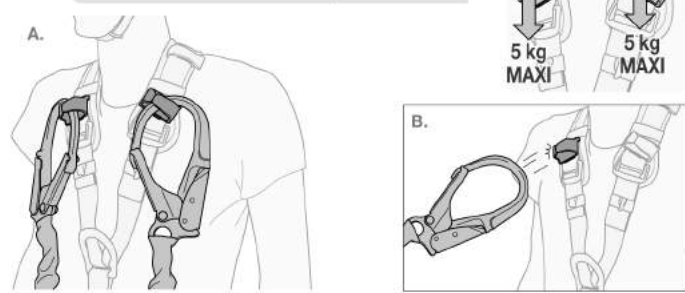

Am'D SCREW-LOCK

CE 0082 EN 362: 2004 EAC TPTC 019/2011

	27 kN
	8 kN
	7 kN
	24 mm

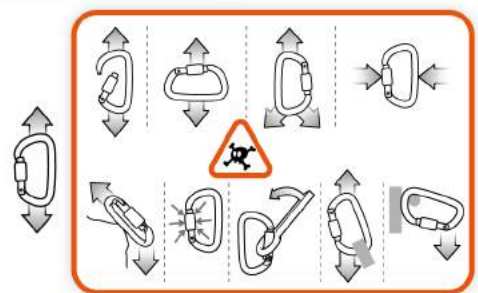

12. Additional information / Informations complémentaires



A. Lifetime / Durée de vie

Serial n° / N° de série
 XXX XX XXXX + 10 years ans

B. Markings / Marquage



C. Acceptable T° / T° tolérées

+ 80°C / + 176°F
 - 40°C / - 40°F

D. Precautions for use / Précautions d'usage



E. Cleaning - Disinfection / Nettoyage - Désinfection



F. Drying / Séchage



G. Storage - Transport / Stockage - transport



I. Modifications - Repairs / Modifications - Réparations



J. FAQ - Contact / Questions - Contact



Traceability and markings / Traçabilité et marquage

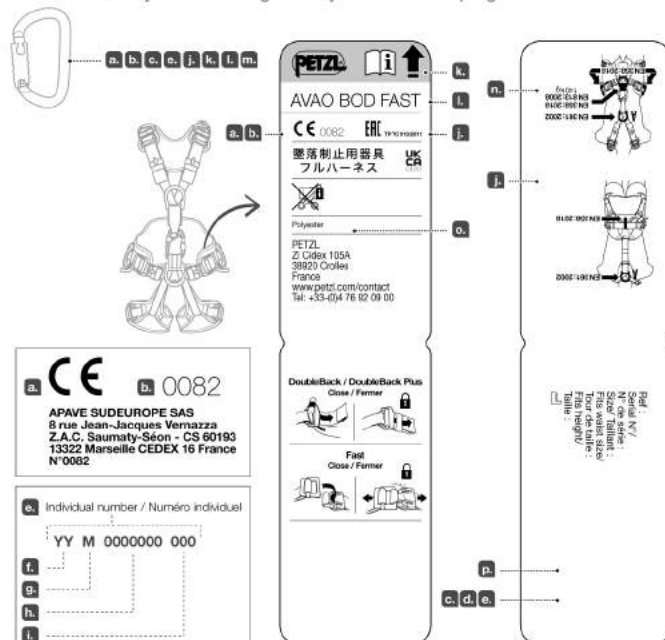

PETZL
 FR-38920 Croilles
 Cidex 105A
PETZL.COM
 ISO 9001
 © Petzl



EAC SPECIFICATIONS / Стандарты EAC

ГОСТ Р ЕН 361: 2008
 ГОСТ Р ЕН 358: 2008
 ГОСТ Р ЕН 813: 2008



This product is compliant with the Regulation 2016/425 on Personal Protective Equipment as brought into UK law and amended.
 Ce produit est conforme au règlement 2016/425 sur les équipements de protection individuelle tel que transposé en droit britannique et modifié.

Approved body performing the UKCA type examination and the production control of this PPE:
 Organisme approuvé intervenant pour l'examen UKCA de type et le contrôle de production de cet EPI:

SGS United Kingdom Ltd
 Inward Way
 Rossmore Business Park
 Ellesmere Port, Cheshire, CH65 3EN
 United Kingdom
 N° 0120

Authorized Representative in UK: PETZL
 UK Agency, Unit 5-7, Tabby Business Park, Old Tabby, Penrith, CA10 3SS, United Kingdom

These instructions explain how to correctly use your equipment. Only certain techniques and uses are described. The warning symbols inform you of some potential dangers related to the use of your equipment, but it is impossible to describe them all. Check Petzl.com for updates and additional information. You are responsible for heeding each warning and using your equipment correctly. Any misuse of this equipment will create additional dangers. Contact Petzl if you have any doubts or difficulty understanding these instructions.

1. Field of application

Personal protective equipment (PPE) used for fall protection. Fall arrest body harness, work positioning and restraint belt and seat harness for work at height. Nominal maximum load: 140 kg. This product must not be pushed beyond its limits, nor be used for any purpose other than that for which it is designed.

Responsibility

WARNING

Activities involving the use of this equipment are inherently dangerous. You are responsible for your own actions, decisions and safety.

Before using this equipment, you must:

- Read and understand all Instructions for Use.
- Get specific training in its proper use.
- Become acquainted with its capabilities and limitations.
- Understand and accept the risks involved.

Failure to heed any of these warnings may result in severe injury or death.

This product must only be used by competent and responsible persons, or those placed under the direct and visual control of a competent and responsible person. You are responsible for your actions, your decisions and your safety and you assume the consequences of same. If you are not able, or not in a position to assume this responsibility, or if you do not fully understand the Instructions for Use, do not use this equipment.

2. Nomenclature

Chest harness.

(1) Dorsal attachment point, (2) Rear dorsal point adjustment buckle, (3) Front shoulder strap adjustment buckles, (4) Sternal attachment point, (5) Chest harness-seat harness connector, (6) CAPTIV, (7) Elastic keepers for straps, (8) Velcro keeper for ASAP SORBER, (9) Fall-arrest lanyard connector-holders.

Seat harness:

(10) Textile attachment point for Am'D connector, (11) Waistbelt straps, (12) Leg loops, (13) Metal ventral attachment point, (14) Waistbelt side attachment points, (15) Rear restraint attachment point, (16) DOUBLEBACK adjustment buckles for straps, (16 bis) FAST LT buckles for leg loops, (17) Equipment loops, (18) Loops for TOOLBAG tool pouch, (19) DOUBLEBACK adjustment buckles for leg loop-waistbelt linking straps, (20) Loops for CARITOOL tool holder.

Principal materials:

Straps: polyester.
Adjustment buckles: steel.
Metal attachment points and connector: aluminum alloy.

3. Inspection, points to verify

Your safety depends upon the integrity of your equipment. Petzl recommends a detailed inspection by a competent person at least once every 12 months (depending on current regulations in your country, and your conditions of usage). WARNING: your intensity of use may cause you to inspect your PPE more frequently. Follow the procedures described at Petzl.com. Record the results on your PPE inspection form: type, model, manufacturer contact info, serial number or individual number, dates: manufacture, purchase, first use, next periodic inspection; problems, comments, inspector's name and signature.

Before each use

Harness

Check the webbing at the attachment points, at the adjustment buckles and at the safety stitching. Be particularly careful to check for cut or loose threads. Look for cuts, wear and damage due to use, to heat, to chemicals... Verify that the DOUBLEBACK PLUS and FAST LT buckles function properly.

Am'D SCREW-LOCK connector

Verify the absence of any cracks, deformation, corrosion or wear on the frame, rivet, gate, and locking sleeve. Verify that the gate opens, and that it closes automatically and completely. The Keylock hole must not be blocked or plugged. Check that the locking sleeve locks and unlocks.

During use

Verify that the carabiner is always loaded on the major axis. Regularly check that the locking sleeve is locked. Avoid any pressure or rubbing that could unlock the gate or damage the locking sleeve. Regularly verify that the adjustment buckles are securely fastened. It is important to regularly monitor the condition of the product and its connections to the other equipment in the system. Make sure that all items of equipment are correctly positioned with respect to each other.

4. Compatibility

Verify that this product is compatible with the other elements of the system in your application (compatible = good functional interaction). Equipment used with your harness must meet current standards in your country (e.g. EN 362 connectors). The harness comes with an Am'D SCREW-LOCK connector which may be replaced with an Am'D TRIACT-LOCK, an OK SL or an OK TL (2017 version), an OXAN SL or an OXAN TL (2017 version). Refer to the Instructions For Use of the corresponding products. The CAPTIV must be used with your connector.

5. Harness setup

- Be sure to correctly stow the excess webbing (folded flat) in the elastic keepers.
- Beware of foreign objects that could impede the operation of the FAST buckles (e.g. pebbles, sand, clothing...). Verify that they are correctly fastened (see diagrams).

Am'D SCREW-LOCK connector

A carabiner is not indestructible.

A carabiner is strongest when loaded on the major axis, with the gate closed. Loading a carabiner in any other way (e.g. on the minor axis or with the gate open) is dangerous and can reduce its strength.

Initial adjustment of the dorsal attachment point

Adjust the position of the dorsal attachment point to suit your body shape and size: position it at the level of the shoulder blades. WARNING: adjustment of the leg loop-waistbelt linking straps is important if you use the dorsal point.

Adjustment and suspension test

Your harness must be adjusted to fit snugly in order to reduce the risk of injury in case of a fall. In a safe environment, you must move around and hang in the harness from each attachment point, with your equipment, to verify that the harness fits properly, provides adequate comfort for the intended use and that it is optimally adjusted.

6. EN 361: 2002 full-body fall-arrest harness

Full-body harness for fall protection, component of a fall-arrest system in accordance with the EN 363 standard (personal fall protection systems).

6A. Sternal attachment point

6B. Dorsal attachment point

Only these points may be used to attach a fall-arrest system, for example a mobile fall arrester, an energy absorber, or other system described in the EN 363 standard. For ease of identification, these points are marked with the letter 'A'.

Clearance: amount of free space below the user

The free space below the user must be sufficient to prevent the user from hitting an obstacle in case of a fall. Specific details on calculating clearance are found in the Instructions for Use of the other components (energy absorbers, mobile fall arrester...).

7. EN 358: 2018 belt for restraint and work positioning

These attachment points must only be used to attach to a work positioning system or a restraint system - maximum fall height: 0.6 m. See the Instructions for Use of the lanyard used, for usage precautions.

Do not use a work positioning belt if there is a foreseeable risk of the user becoming suspended or exposed to uncontrolled tension on the belt. For work positioning, use an anchor point situated at or above waist level.

These attachment points are not designed for fall-arrest usage. It may be necessary to supplement work positioning or travel restraint systems with collective or personal fall-arrest systems.

The waistbelt is approved for one user, including his/her tools and equipment, for a maximum total weight of 150 kg.

7A. Ventral attachment point

7B. Waistbelt side attachment points

Always use the two side attachment points together, by linking them with a positioning lanyard, in order to be comfortably supported by the waistbelt.

7C. Rear restraint attachment point

This rear waistbelt attachment is designed only for attachment of a restraint system to prevent the user from entering an area where a fall is possible.

8. EN 813: 2008 seat harness

Ventral attachment point

Designed for progression on rope and work positioning. Use the ventral point (textile or metal) to attach a descender, positioning lanyards, progression lanyards, or the PODIUM seat. This attachment point is not suitable for fall arrest.

9. CAPTIV connector positioning bar

The CAPTIV positioning bar promotes positioning of the connector along its major axis. WARNING: replace the CAPTIV removable bar if you change the connector.

10. Equipment loops

Equipment loops must only be used for equipment. WARNING - DANGER: never use equipment loops for belaying, rappelling, tying in, or anchoring a person. The Velcro keeper may be used to hold your mobile fall arrester's energy absorber in a high position.

11. Fall-arrest lanyard connector holder

A. To be used only as a connector holder for unused lanyard ends.
B. In case of a fall, the connector holder releases the lanyard end connector so as to avoid impeding deployment of the energy absorber. WARNING: this attachment point is not a fall-arrest attachment point.

12. Additional information

This product meets the requirements of Regulation (EU) 2016/425 on personal protective equipment. The EU declaration of conformity is available at Petzl.com. The melting point of high-modulus polyethylene (140° C) is lower than that of nylon and polyester.
- You must have a rescue plan and the means to rapidly implement it in case of difficulties encountered while using this equipment.
- The anchor point for the system should preferably be located above the user's position and should meet the requirements of the EN 795 standard (12 kN minimum strength).
- In a fall-arrest system, it is essential to check the required clearance below the user before each use, in order to avoid any impact with the ground or with an obstacle in case of a fall.
- Make sure that the anchor point is correctly positioned, in order to limit the risk and the length of a fall.
- A fall-arrest harness is the only device allowable for supporting the body in a fall-arrest system.
- When using multiple items of equipment, a dangerous situation can arise in which the safety function of an item of equipment can be affected by the safety function of another item of equipment.
- WARNING: ensure that your products do not rub against abrasive or sharp surfaces.
- Users must be medically fit for activities at height. WARNING: inert suspension in a harness can result in serious injury or death.
- The Instructions for Use for each item of equipment used in conjunction with this product must be followed.
- The Instructions for Use must be provided to the user of this equipment, in the language of the country where the equipment is used.
- Make sure the markings on the product are legible.

When to retire your equipment:

WARNING: an exceptional event can lead you to retire a product after only one use, depending on the type and intensity of usage and the environment of usage (harsh environments, marine environments, sharp edges, extreme temperatures, chemicals...).

A product must be retired when:

- It is over 10 years old and made of plastic or textiles.
 - It has been subjected to a major fall or load.
 - It fails to pass inspection. You have any doubt as to its reliability.
 - You do not know its full usage history.
 - When it becomes obsolete due to changes in legislation, standards, technique or incompatibility with other equipment...
- Destroy these products to prevent further use.

Icons:

A. Lifetime: 10 years - B. Marking - C. Acceptable temperatures - D. Usage precautions - E. Cleaning/disinfection - F. Drying - G. Storage/transport - H. Maintenance - I. Modifications/repairs (prohibited outside of Petzl facilities, except replacement parts) - J. Questions/contact

3-year guarantee

Against any material or manufacturing defect. Exclusions: normal wear and tear, oxidation, modifications or alterations, incorrect storage, poor maintenance, negligence, uses for which this product is not designed.

Warning symbols

1. Situation presenting an imminent risk of serious injury or death. 2. Exposure to a potential risk of accident or injury. 3. Important information on the functioning or performance of your product. 4. Equipment incompatibility.

Traceability and markings

a. Meets PPE regulatory requirements. Notified body performing the EU type examination - b. Number of the notified body responsible for the production control of this PPE - c. Traceability; datamatrix - d. Sizing - e. Serial number - f. Year of manufacture - g. Month of manufacture - h. Batch number - i. Individual identifier - j. Standards - k. Read the Instructions for Use carefully - l. Model identification - m. Class (B basic) - n. Nominal maximum load - o. Manufacturer address - p. Date of manufacture (month/year)